

# Homes For Wildlife

**Nest boxes and platforms for use in extensive stands of deciduous or coniferous forest.**

## **Barred Owl**

The barred owl is one of our more common owls in hardwood forests. Its call is a distinctive "Who-cooks-for-you." Its blue eyes are unique among Minnesota's owls. The barred owl nest box is made of 3/4-inch thick exterior grade plywood. Do not paint, stain, or treat the box with creosote. Put a 2 to 3 inch layer of small wood chips in the bottom of the box. No cleaning is needed except to remove leaves and other litter that squirrels put into the box. The entrance hole is 7 inches wide and 7 inches high with a rounded top and rounded corners at the bottom. The hole can be either on the front or on a side, but if it is on the side the box is easier to clean. This box can be cleaned out through the hole, so the roof does not need to be hinged.

The box should be cleaned out or placed in January. The box should be located 20 to 30 feet high in a mature lowland hardwood area, and preferably within 200 feet of water. Do not place the box on the edge of a clearing or within 150 feet of a residence. The entrance hole should not be obscured by branches or leaves, but a perch near the nest box is desirable. This perch should be near enough to the box so that the young can "branch" out onto it as they leave the nest. Otherwise they may fall to the ground and be eaten by predators. The box should be placed on a living tree which is at least 12 inches in diameter. There may be a slight preference for west-facing entrance holes.

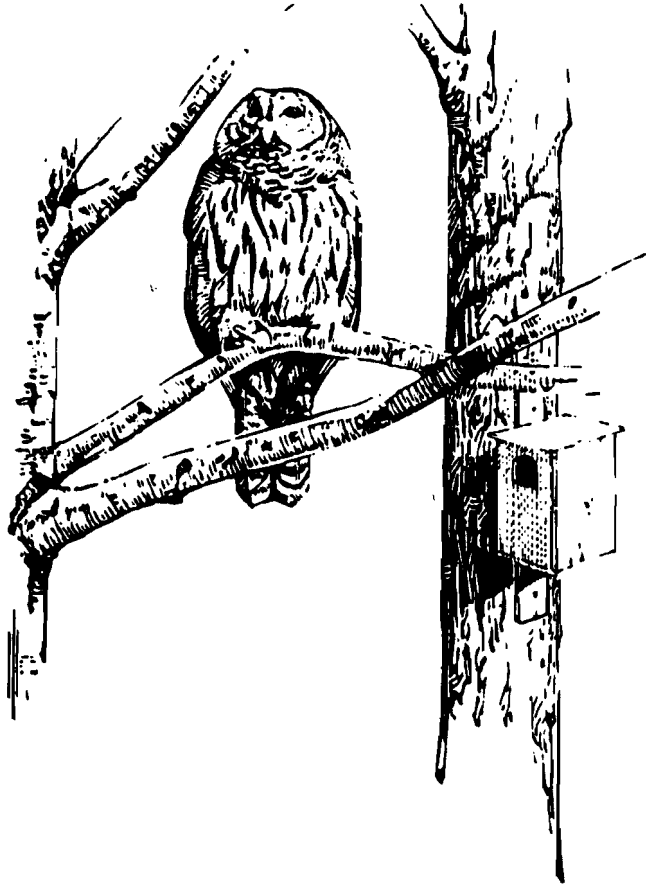

Compliments of:

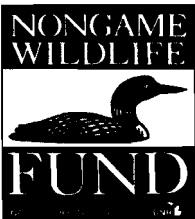

### **MICHIGAN'S WILDLIFE NEED YOUR HELP.**

"Look For the Loon" on your State income tax form and give to the Nongame Wildlife Fund. You can make a direct contribution to the Fund with a check made payable to: "Nongame Wildlife Fund." Mail to: Department of Natural Resources, Wildlife Division, Dept. BBP, P.O. Box 30180, Lansing, MI 48909.

Your contributions are the primary support for critically important work for Michigan's nongame wildlife and endangered plants and animals.

Acknowledgement: Minnesota DNR,  
Nongame Wildlife Program

## Barred Owl Nest Box

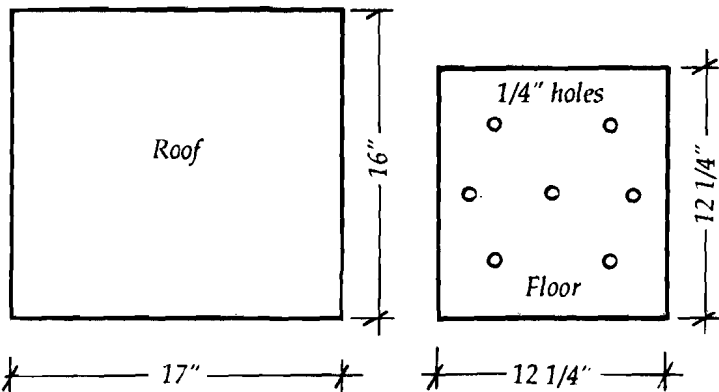
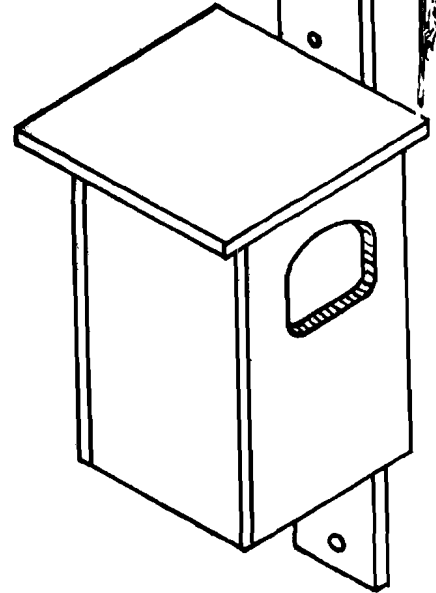
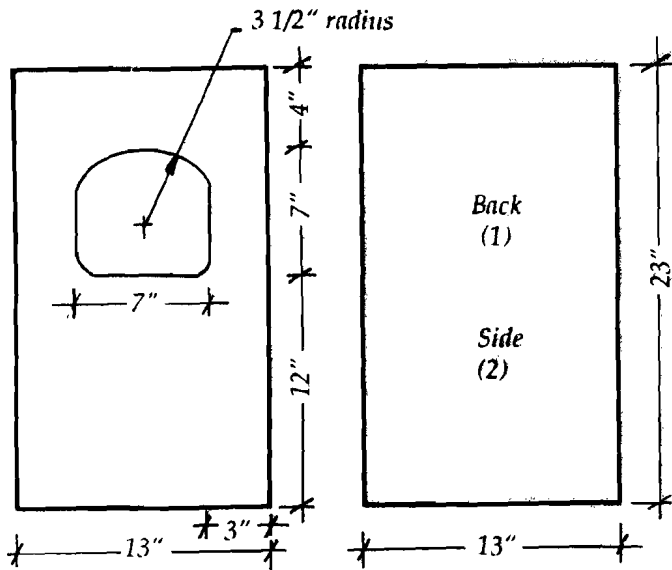
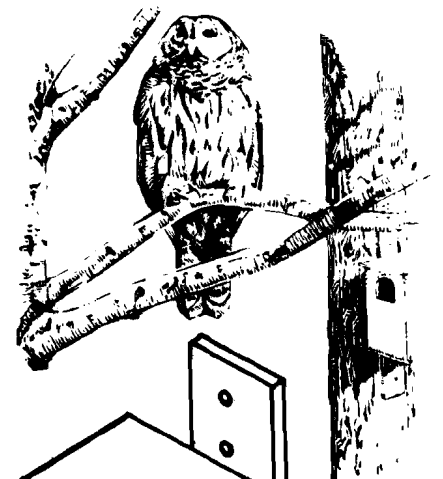

Note: No hinged door needed.  
Clean through entrance hole.

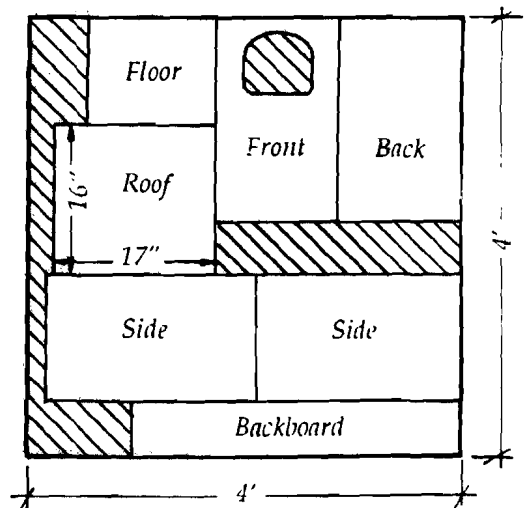
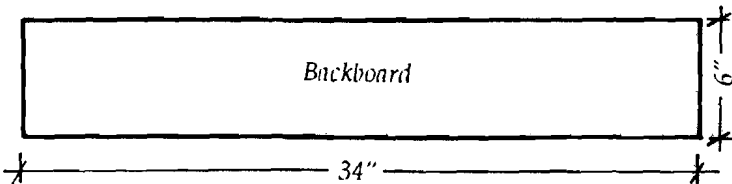

Lumber: One 4' x 4' x 3/4" sheet exterior plywood.

### EQUAL RIGHTS FOR NATURAL RESOURCE USERS

The MI Department of Natural Resources (MDNR) provides equal opportunities for employment and for access to Michigan natural resources. State and federal laws prohibit discrimination on the basis of race, color, sex, national origin, religion, disability, age, marital status, height and weight. If you believe that you have been discriminated against in any program, activity, or facility, please write the MDNR Equal Opportunity Office, P. O. Box 30028, Lansing, MI 48909, or the MI Department of Civil Rights, 1200 6th Avenue, Detroit, MI 48826, or the Office of Human Resources, U. S. Fish and Wildlife Service, Washington, DC 20240.

For information or assistance on this publication, contact MDNR, Wildlife Division, P. O. Box 30444, Lansing, MI 48909-7944.

Michigan Department of Natural Resources  
Wildlife Division  
Natural Heritage Program

